

MODELS

7101	1" Female Thread, NPT
7101-SL	1" Female Slip
7101-BSP	1" Female Thread, Female BSP Inlet and Outlet
7101-J	1" Female Thread Jar-Top, NPT
7101-J-SL	1" Female Slip Jar-Top
7101-J-BSP	1" Female Thread Jar-Top, BSP

PRO SERIES 150 VALVES

K-Rain's ProSeries 150 Valves offer the irrigation professional a wide array of features and benefits.

The 1" valve has a removable metering pin and external bleed screw promoting easy maintenance and manual operation.

The Jar-Top provides the professional easy servicing access without removing the valve from the system.



7101

7101-J



NO TOOLS NEEDED

The K-Rain Jar-Top valve allows for quick and easy servicing after installation.



MANUAL EXTERNAL BLEED SCREW

The 1", 1 1/2" and 2" models feature a removable external bleed screw and metering pin to simplify cleaning and maintenance. With the External Bleed Screw, manual operation during start up is easy.

HOW TO SPECIFY

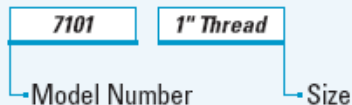

FEATURES/BENEFITS ProSeries 150 - 1" Valve

- Heavy Duty, Corrosion and UV Resistant PVC Construction –Increases the life of the valve.
- External Bleed Screw with Removable Metering Pin–Allows for easy cleaning of the metering pin without disassembling the valve.
- Manual External Bleed Screw–Provides for manual operation in system start up.
- Manual Internal Bleed through Solenoid–Provides for manual operation without discharging water outside the valve.
- Captured Plunger Solenoid–Allows for the solenoid to be removed without losing the internal plunger.
- Two Year Limited Warranty.

FEATURES/BENEFITS ProSeries 150 - 1" Jar-Top Valve

- Heavy Duty, Corrosion and UV Resistant PVC Construction –Increases the life of the valve.
- Threaded Jar-Top–Allows for quick removal of the cap for easy servicing after installation.
- Manual External Bleed Screw–Provides for manual operation in system start up.
- Manual Internal Bleed through Solenoid–Provides for manual operation without discharging water outside the valve.
- Captured Plunger Solenoid–Allows for the solenoid to be removed without losing the internal plunger.
- Glass-Filled Nylon Screw Cap–Increased durability.
- Two Year Limited Warranty.

SPECIFICATIONS

Operating Specifications

- Pressure range: 10-150 psi
- Flow Range: .25 - 30 GPM

Electrical Specifications

- Standard solenoid: 24 VAC 60 Cycle
- Inrush current: .4 amp
- Holding current: .2 amp

ProSeries 150 1" VALVE-7101

- Dimensions: HEIGHT: 5 1/4" WIDTH: 3 1/8" LENGTH: 5"

ProSeries 150 1" VALVE WITH JAR-TOP -7101-J

- Dimensions: HEIGHT: 5 1/4" WIDTH: 3" LENGTH: 4 3/8"

OPERATING SPECIFICATIONS

ProSeries 150 1" VALVE

FLOW RATE - GPM	5	10	15	20	30
PSI LOSS	2.9	2.1	1.8	3.0	5.0

ProSeries 150 1" VALVE WITH JAR-TOP

FLOW RATE - GPM	5	10	15	20	30
PSI LOSS	3.3	3.9	2.9	3.2	6.1

PRESSURE RANGE: 10-150 PSI

MODELS

7115	1 1/2" Female Thread, NPT
7115-BSP	1 1/2" Female Thread, Female BSP Inlet and Outlet
7102	2" Female Thread, NPT
7102-BSP	2" Female Thread, Female BSP Inlet and Outlet

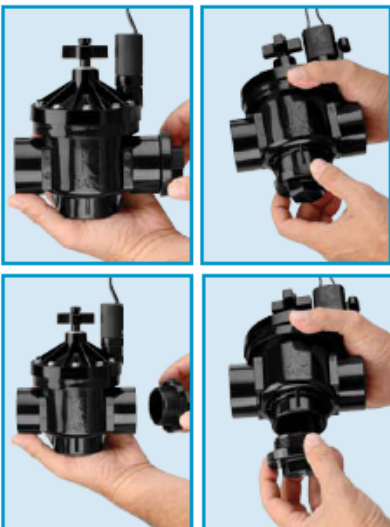

PROSERIES 150 VALVES

The 1.5" and 2" models feature a removable inlet cap to easily modify the configuration from globe to angle style. They also have a removable metering pin and external bleed screw promoting easy maintenance and manual operation.



HOW TO SPECIFY

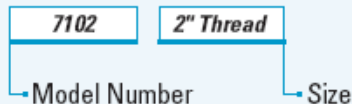

SYSTEM FLEXIBILITY

Removable inlet cap allows for easy conversion from globe to angle-style valve.



FEATURES/BENEFITS ProSeries 150 - 1 1/2" & 2" Valves

- Heavy Duty, Corrosion and UV Resistant PVC Construction –Increases the life of the valve.
- External Bleed Screw with Removable Metering Pin–Allows for easy cleaning of the metering pin without disassembling the valve.
- Manual External Bleed Screw–Provides for manual operation in system start up.
- Manual Internal Bleed through Solenoid–Provides for manual operation without discharging water outside the valve.
- Removable Inlet Cap–Allows for easy conversion from globe to angle-style valve.
- Captured Plunger Solenoid–Allows for the solenoid to be removed without losing the internal plunger.
- Heavy Duty Santoprene Diaphragm–Unique design improves durability of diaphragm.
- Two Year Limited Warranty.

SPECIFICATIONS

Operating Specifications

- Pressure range: 20-150 psi
- Flow Range: 5 - 120 GPM

Electrical Specifications

- Standard solenoid: 24 VAC 60 Cycle
- Inrush current: .4 amp
- Holding current: .2 amp

ProSeries 150 1 1/2" VALVE-7115

- Dimensions: HEIGHT: 8" WIDTH: 4 1/4" LENGTH: 5 1/2"

ProSeries 150 2" VALVE-7102

- Dimensions: HEIGHT: 8 7/8" WIDTH: 4 7/8" LENGTH: 6 1/3"

OPERATING SPECIFICATIONS

ProSeries 150 1 1/2" VALVE

FLOW RATE - GPM	20	30	40	50	60	80	
PSI LOSS	GLOBE	3.0	2.6	2.3	2.9	4.1	5.5
	ANGLE	2.7	2.2	1.9	2.2	3.0	4.4

ProSeries 150 2" VALVE

FLOW RATE - GPM	20	30	40	50	60	80	100	120	
PSI LOSS	GLOBE	2.0	1.9	1.7	1.5	1.6	2.9	4.8	6.2
	ANGLE	1.9	1.9	1.7	1.5	1.5	2.1	3.2	4.6

PRESSURE RANGE: 10-150 PSI